

Type : T Cores

Ordering Code:

Shape:

P4	T28*16*13	C	G□
Material 材質	Core Size 品名	Coating 塗裝	Gapped AL Value

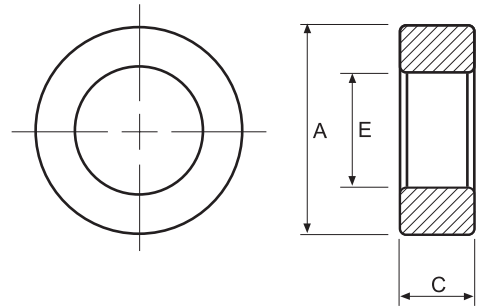

C : Epoxy Coating of Halogen-Free HUC : Epoxy Coating of UL & Halogen-Free
 HP : Parylene Coating of Halogen-Free W : Powder Coating of Halogen-Free

■ DIMENSIONS AND EFFECTIVE PARAMETERS

CORES	DIMENSIONS (mm)			EFFECTIVE PARAMETERS				
	EPOXY COATING DIMENSIONS (mm)			C _i (mm ⁻¹)	Le(mm)	Ae(mm ²)	Ve(mm ³)	Wt(g/set)
	A	E	C					
T26x14.5x10	26.00 ± 0.40	14.50 ± 0.30	10.00 ± 0.30	1.08	60.14	55.89	3361.47	17.68
	27.00max	13.60min	10.90max					
T26.4x14.5x10.2	26.40 ± 0.40	14.50 ± 0.40	10.20 ± 0.30	1.03	60.56	58.91	3567.13	18.92
	27.40max	13.50min	11.10max					
T27x18x11.5	27.00 ± 0.40	18.00 ± 0.40	11.50 ± 0.30	1.74	69.54	39.92	331.36	18.29
	28.00max	17.00min	12.40max					
T28x12x12	28.00 ± 0.40	12.00 ± 0.30	12.00 ± 0.25	0.62	55.90	90.46	5056.48	28.62
	29.00max	11.10min	12.85max					
T28x14x12	28.00 ± 0.60	13.80 ± 0.40	12.00 ± 0.40	0.76	60.97	80.72	4921.46	26.60
	29.20max	12.80min	13.00max					
T28x16x13	28.00 ± 0.50	16.00 ± 0.40	13.00 ± 0.40	0.86	65.64	76.00	4988.00	26.30
	29.10max	15.00min	14.00max					
T28x18x16	28.00 ± 0.50	18.00 ± 0.40	16.00 ± 0.40	0.89	69.96	78.71	5506.49	26.57
	29.10max	17.00min	17.00max					
T29x19x7.49	29.00 ± 0.50	19.00 ± 0.35	7.49 ± 0.30	1.98	73.20	36.90	2700.75	12.90
	30.10max	18.05min	8.24max					
T29x19x15.2	29.00 ± 0.50	19.00 ± 0.35	15.20 ± 0.30	0.98	73.20	74.88	5480.84	27.73
	30.10max	18.05min	16.00max					
T31x19x6	31.00 ± 0.50	19.00 ± 0.50	6.00 ± 0.30	2.14	75.49	35.29	2663.95	13.22
	32.10max	17.90min	6.90max					
T31x19x8	31.00 ± 0.50	19.00 ± 0.50	8.00 ± 0.30	1.60	75.49	47.05	3551.93	18.12
	32.10max	17.90min	8.90max					
T31x19x12	31.00 ± 0.50	19.00 ± 0.50	12.00 ± 0.40	1.07	75.49	70.58	5327.90	26.99
	32.10max	17.90min	13.00max					
T31x19x13	31.00 ± 0.50	19.00 ± 0.50	13.00 ± 0.40	0.99	75.49	76.46	5771.89	29.04
	32.10max	17.90min	14.00max					
T31x19x16	31.00 ± 0.50	19.00 ± 0.50	16.00 ± 0.40	0.80	75.49	94.11	7103.86	35.74
	32.10max	17.90min	17.00max					
T31x20x15	31.00 ± 0.50	20.00 ± 0.50	15.00 ± 0.50	0.96	77.60	81.19	6300.71	30.72
	32.10max	18.90min	16.00max					
T34.4x20.2x12.6	34.40 ± 0.50	20.20 ± 0.50	12.60 ± 0.40	0.94	81.84	87.38	7151.28	36.92
	35.50max	19.10min	13.60max					
T34.74x5.4x1.0	34.74 ± 0.50	5.40 ± 0.25	1.00 ± 0.10	3.38	37.39	11.08	414.22	4.23
	-	-	-					
T36x23x15	36.00 ± 0.60	23.45 ± 0.50	15.00 ± 0.40	0.93	89.65	95.89	8595.89	41.37
	37.20max	22.35min	16.00max					
T36x23Ax22	36.00 ± 0.60	23.45 ± 0.50	22.00 ± 0.40	0.67	90.58	135.96	12315.43	62.50
	37.20max	22.35min	23.00max					
T36x25x11.3	36.00 ± 0.50	25.00 ± 0.40	11.30 ± 0.30	1.52	93.73	61.47	5761.05	27.30
	37.10max	24.00min	12.20max					
T36x26x10	36.00 ± 0.60	26.00 ± 0.50	10.00 ± 0.40	1.93	95.69	49.56	4742.57	19.50
	37.20max	24.90min	11.00max					
T37x22x15	37.00 ± 0.60	22.00 ± 0.50	15.00 ± 0.40	0.81	88.63	110.00	9749.34	50.51
	38.20max	20.90min	16.00max					
T38x19x13	38.10 ± 0.60	19.05 ± 0.60	13.00 ± 0.30	0.70	82.75	118.67	9819.89	53.19
	39.30max	17.85min	13.90max					
T38x20.5x13.8	38.00 ± 0.50	20.50 ± 0.30	13.80 ± 0.30	0.74	86.31	116.99	10097.03	52.20
	39.10max	19.60min	14.80max					
T38x22x14	38.00 ± 0.60	22.00 ± 0.60	14.00 ± 0.40	0.82	89.71	109.25	9801.55	50.07
	39.20max	20.80min	15.00max					



MANUFACTURING CAPABILITY

Gapped Toroid Sizes(OD)	12.00mm - 38.00mm
Height	3.00mm - 15.00mm
Gap Sizes :	0.45mm - 2.00mm
AL Tolerance	AL ± 10%

APPLICATIONS

- Power**
 - DC-DC Converters
 - Compact Power Transformer
 - Small, Low Profile Power Inductors
- Telecom**
 - xDSL pass-band Filiterers
 - Spilters
 - EMI Inductors
 - Filiter Inductors with Tight Tolerance

■ ELECTRICAL CHARACTERISTICS

CORES	AL ± 25% (nH/N ²)					AL ± 30% (nH/N ²)				
	P4	P47	P5	A05	A07	A10	A102	A121	A13	A151
T26x14.5x10				5680		11370	11370			
T26.4x14.5x10.2				5940		11880	11880			
T27x18x11.5					6200	8400		10000		
T28x12x12	6500									
T28x14x12		5100								
T28x16x13	3550	4300		7200	9900	14110	14110	17000		
T28x18x16				6960						
T29x19x7.49	1580	1900		3170	4430	6340	6340	7495		
T29x19x15.2	3220	3800	2500	6440	9020	12890	12890	15200		
T31x19x6	1465			2940	4110	5880	5880	6910		
T31x19x8	1965		1560	3920	5480	7830	7830	9220		
T31x19x12	2930			5870	8220	11740	11740			
T31x19x13	3180	3820	2500	6360	8910	12730	12730	14500		
T31x19x16	3840			7685	10760	15200	15200	18400		
T31x20x15				6470	9200	13150				
T34.4x20.2x12.6	3270	4000		6560	9180					
T34.74x5.4x1.0	830									
T36x23x15	3210			6430	9000	12860	12860	14500		
T36x23Ax22					11800					
T36x25x11.3	2100									
T36x26x10	1650									
T37x22x15	3900			7790	10900	15500	15500	13000min		
T38x19x13	4200	5200	3350	8400	11800	16800	16800	20800	20800	
T38x20.5x13.8										
T38x22x14	3820			7650	10710	15300				

Remark:

1. AL Value Testing Condition : 10kHz, 50mV, 1Ts. If testing condition is different from ACME's, please specify upon request & ordering.
2. Coating Material
 - (1) Toroid Size T8 and Below:clear parylene coating, breakdown voltage:1000Vdc, coating thickness : 0.05mm max.
 - (2) Toroid Size T9 and Above:green epoxy coating, breakdown voltage:1500Vdc, coating thickness : 0.6mm max.
3. Customized dimensions are available.